



G/18/107

**FOR SALE  
OUTLECKAN ROAD  
BELLEEK  
CO. ARMAGH**

**AGRICULTURAL LANDS EXTENDING TO APPROX. 29.50 ACRES  
FOR SALE**



**GUIDE PRICE: - OFFERS AROUND – £245,000**

**CLOSING DATE FOR OFFERS: - 11<sup>th</sup> January 2019**

**(028) 3026 6811**  
**www.bestpropertyservices.com**

**BEST PROPERTY SERVICES (N.I.) LTD**

108 Hill Street, Newry, Co. Down BT34 1BT

Fax. (028) 3026 5607 E-mail: [land@bestpropertyservices.com](mailto:land@bestpropertyservices.com)

Also at:- Armagh and Dundalk

These particulars are given on the understanding that they will not be construed as part of a Contract, Conveyance or Lease and are subject to the Property remaining unsold or unlet. Whilst every care is taken in compiling information, we can give no guarantee as to the accuracy thereof and Enquirers must satisfy themselves regarding the description and measurements formulated here.

## **❑ LOCATION**

---

From Belleeks travel towards Newtownhamilton for approx. 2 miles, turn right onto Outleckan Road and travel for a further 1.5 miles and the subject lands are located on the left handside.

## **❑ AREA**

---

The lands are indicated as field on the attached Land Registry map extending to approx. 29.50 acres (11.94Ha) .

## **❑ OFFERS**

---

Whilst the agents invite offers from interested parties for this property initially on a private basis, we reserve the right on behalf of the Vendors to conclude the bidding (if necessary) by holding a meeting of all bidders on a specified date and time in our office.

In the event that a meeting is to be arranged, only those parties with a valid offer on the property can be assured of being notified of the specific time and date.

## **❑ VIEWING**

---

By inspection at any time.

## **❑ LAND REGISTRY**

---

These lands are comprised within Land Registry Folio:-13174 Co. Armagh.

## **❑ VENDOR'S SOLICITOR**

---

Karen McNally, Luke Curran & Co. Solicitors, 6 Marcus Square, Newry. [Tel:028 30267134](tel:02830267134)

## **❑ GUIDE PRICE**

---

Offers around :- £245,000

## **❑ CLOSING DATE FOR OFFERS**

---

11<sup>th</sup> January 2019

**LAND REGISTRY MAP**

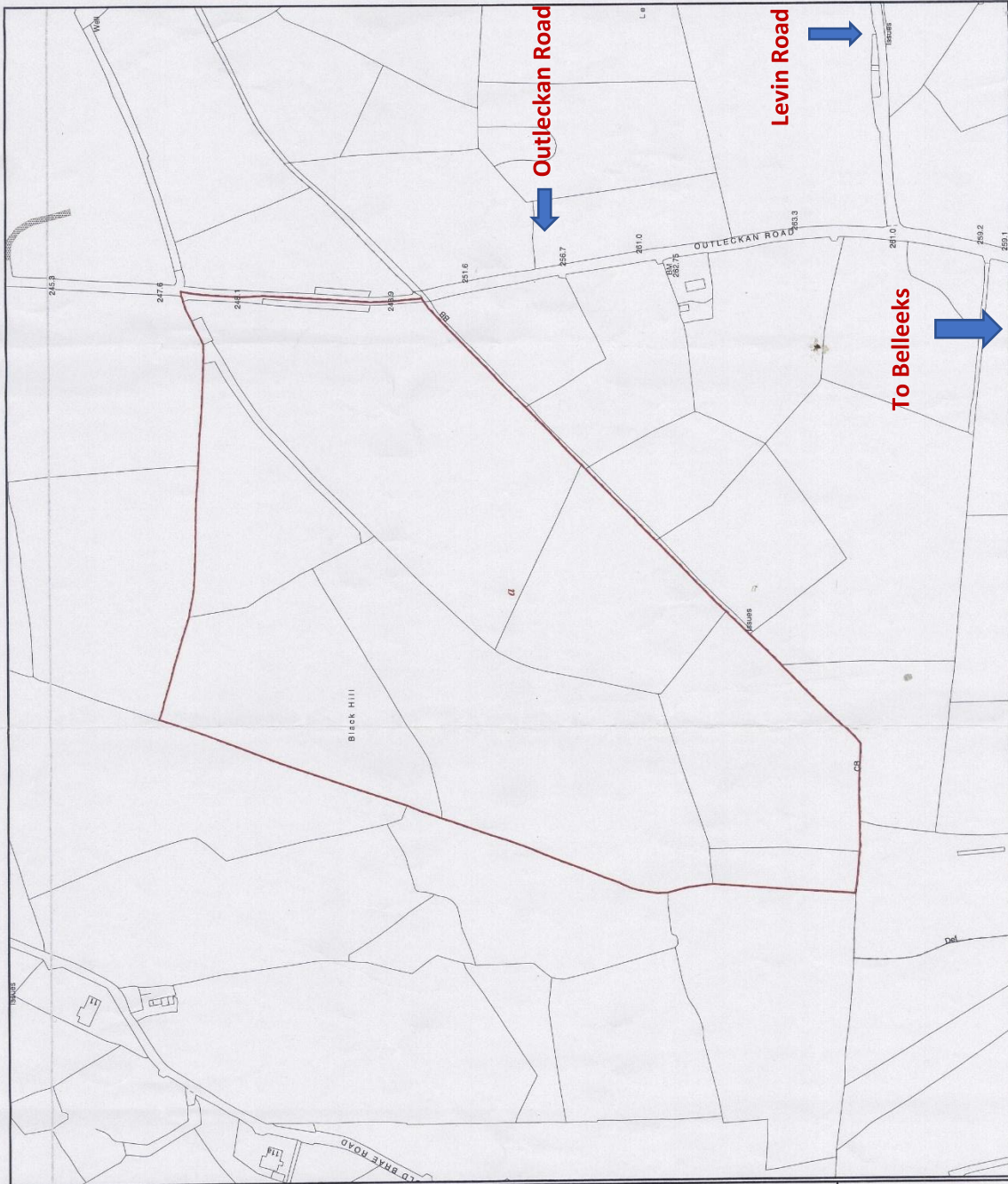

Land & Property Services  
 Seirbhís Talmáin & Maoine  
 THE LAND REGISTRY | CLARLAÍN NÁ TALMÁIN

Date: 12 Apr 2018  
 County: Armagh  
 Folio: 13174  
 Scale: 1:2500  
 Our Ref: 2018/262966  
 Your Ref: KMY/Levin/Outleckan  
 Map Ref(s): 251145N/126502NW  
 Sheet 1 of 1

Key to folio labels:  
 a - 13174

This map is for general purposes only (Scale 1:2500) and is not a substitute for a professional survey. The information shown on this map is derived from the Land Registry's records and is subject to change without notice. The information shown on this map is not to be used for any purpose other than that for which it was prepared. The information shown on this map is not to be used for any purpose other than that for which it was prepared. The information shown on this map is not to be used for any purpose other than that for which it was prepared.

Crown Copyright Reserved  
 This map is a reproduction of the Ordnance Survey map of the area shown. The Ordnance Survey map is a Crown Copyright work and is reproduced here by permission of the Controller of Her Majesty's Stationery Office. Crown Copyright.